

Product family

SKY

SKY combines the smallest sizes with the option of choosing different optics and with a large one range of designs, ideal for starry skies or small light accents, excluding converter (not dimmable or dimmable via PUSH / 1-10V / DALI must be ordered separately)

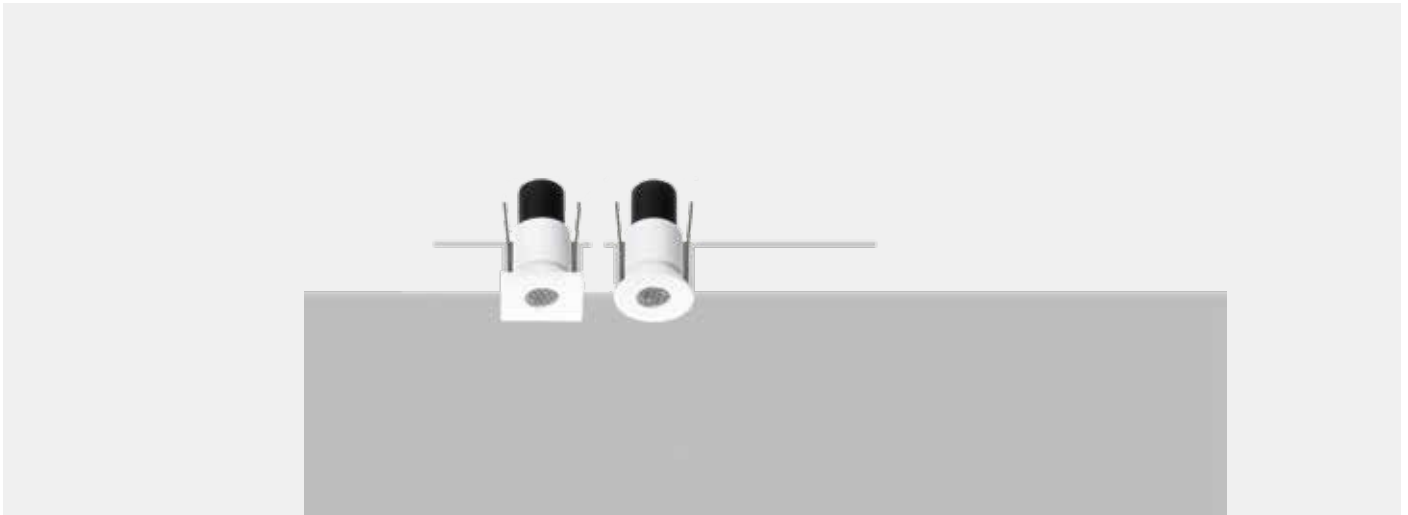

ADVANTAGES

- ideal for starry skies and small light accents
- excl. converter (not dimmable or dimmable via PUSH / 1-10V / DALI must be ordered separately)

CHARACTERISTIC

- Fixed recessed downlight
- 8 selectable housing colors
- Degree of protection IP44
- LED beam angle standard 40 °
- Other light colors and beam angles on request.

Product overview:

Types:

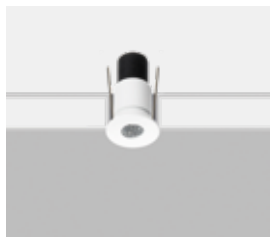

SKY ROUND

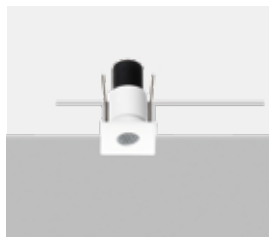

SKY SQUARE

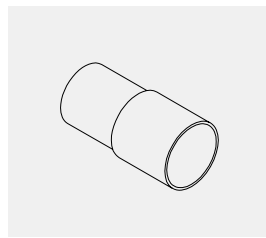

Casting housing for SKY
(optional)

Light emission:



direct

Housing color:



aluminum



bronze



chrome



gold



grey



black



titanium

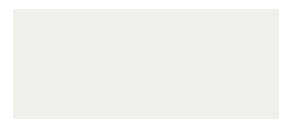

white

Angle:

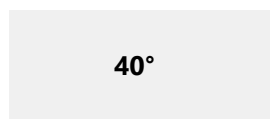

40°

Standard

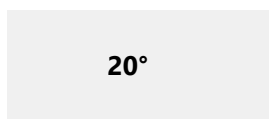

20°

(on request)

Light color:



2700K superwarm white



3000K warm white

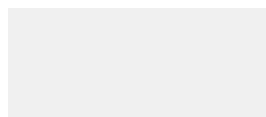

4200K neutral white
(on request)



6000K cold white
(on request)



blue (on request)



green (on request)



red (on request)

Drawings:

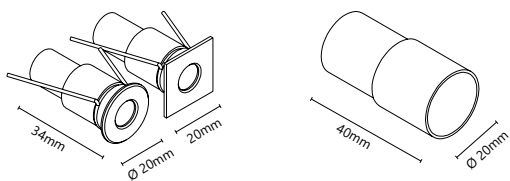

Cut-Out	Ø 15mm
Installation depth	34mm

Article overview:

item number	type	① angle	② kelvin	③ color	
FL-SK1 ① ② ③	SKY ROUND LED 0,75W 250mA	» 2 « 40°	» 0 « 2700K » 1 « 3000K	» A « aluminum	» S « grey
FL-SK2 ① ② ③	SKY SQUARE LED 0,75W 250mA			» B « bronze	» N « black
				» C « chrome	» T « titanium
				» G « gold	» W « white
FL-CS1008	Casting housing for SKY				

Technical information:

SKY

Total watt:	0.75W	
Net lumen:	71lm	75lm
Kelvin (CCT):	2700K	3000K
Angle:	40° Standard	
CRI:	>85Ra	
Light emission:	direct	
Protection:	IP20	
Life expectancy:	50.000h	
Voltage:	100~230V AC/ 250mA DC	